

Assembly instructions for the Amberley Trolley

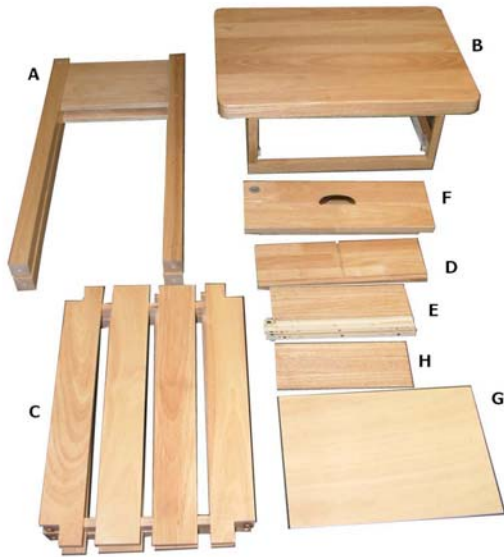

Component List

- A: Leg assembly x 2
- B: Top / Drawer frame assembly
- C: Shelves x 2
- D: Drawer back
- E: Drawer sides
- F: Drawer front
- G: Drawer base
- H: drawer divider



- I: Pack of castors
 - J: Allen Key
 - K: Allen key screws x 12
 - L: Wooden Dowels X 8
 - M: Drawer screws x 8
- * You will also require a Philips screwdriver for assembly

Step 1

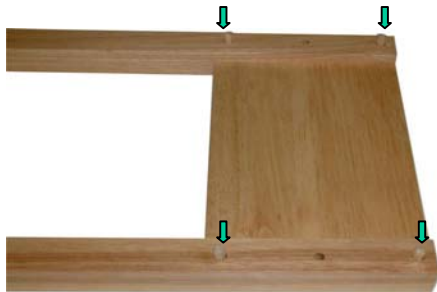

Push 4 wooden dowels (L) into the holes near the top of each leg section (A).

Step 2

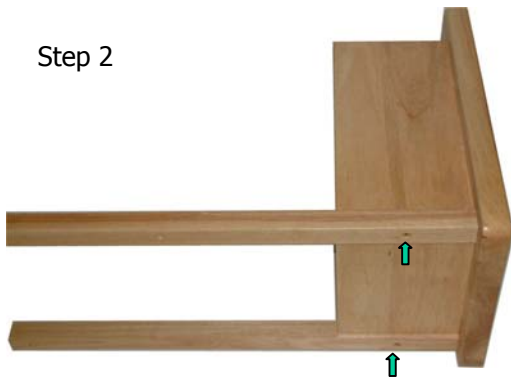

Locate Top/drawer frame (B) onto the dowels on the leg section. Secure with 2 x Allen key screws (K)

Step 3

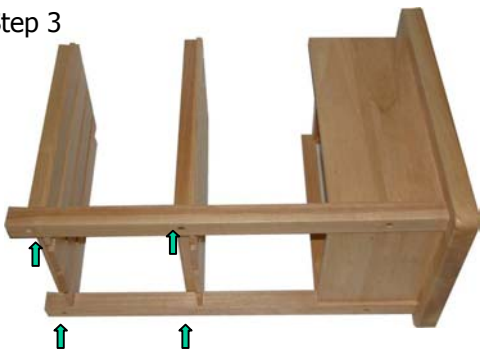

Position shelves (C) onto leg and secure each with 2 Allen key screws (K)

Step 4

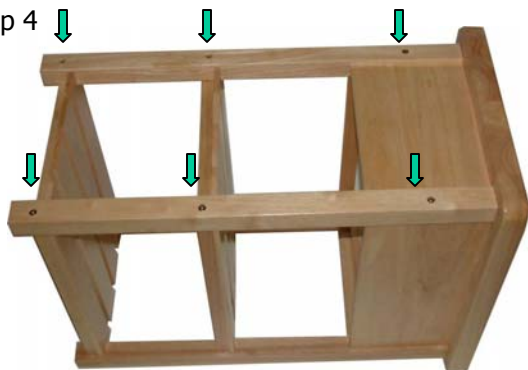

Position remaining leg (A) on to the shelves and drawer frame and secure with 6 Allen key screws (K).

Step 5

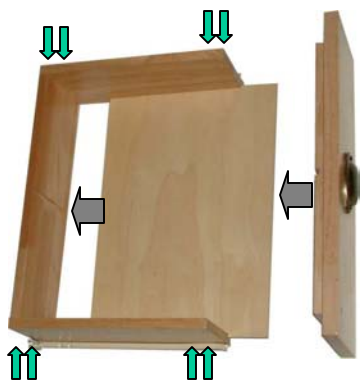

Fix drawer sides (E) to drawer back (D) using 4 small screws (M). Ensure the small wheel on each drawer runner is nearest to the drawer back. Slide the drawer base (G) into groove, then position drawer front (F) onto assembly and secure with 4 small screws (M). Slide drawer divider (H) into grooves on front and back drawer panels.

Step 6

Push castors (I) into the holes in the base of each leg with the 2 locking castors on the front legs of the trolley.

Push the drawer into place on the runners.

Your Amberley trolley is now complete.

